



INSTALLATION GUIDE

Thank you for choosing a B-PWR product, designed by passionate riders who focus on what users really need.

1. SAFETY INSTRUCTIONS

To avoid any unfortunate situations, we recommend that you get to know how your modified vehicle handles before using it in extreme conditions.

Read all the instructions carefully before installing this product.

If you do not have the tools or technical knowledge needed to ensure proper installation, have the product installed by an authorized dealer.

⚠ WARNING

It is essential that you follow the installation procedures, possess general mechanical knowledge and use appropriate tools to ensure a safe and reliable installation of this product.

Any modifications made to your vehicle will change how it handles. Under certain conditions, you may be more likely to lose control of or overturn your modified vehicle, which could result in **SERIOUS INJURIES** or even **DEATH**. You are responsible for understanding how your modified vehicle handles. Wear protective equipment, including head protection, as required.

Improper use or installation of the product, or any modifications made to adapt the product for use in a context other than that for which it was intended, voids the warranty and may result in **SERIOUS INJURIES**.

B-PWR and all its affiliated companies, as well as its suppliers and distributors, are not responsible for any consequences whatsoever resulting from an incorrect installation or an improper use of the product.

This guide provides detailed instructions for installing the product.

AVAILABLE KIT

X-TREME-36

COMPATIBILITY

Polaris snowmobile : RMK/KHAOS

⚠ WARNING

For safety reasons, this kit needs to be installed by a person with general mechanical knowledge using the proper tools.

The illustrations in this document indicate the typical structure of the various assemblies. It is therefore possible that they do not represent the exact form of the parts or the manufacturing details. These illustrations are intended to identify parts that perform an identical or similar function.

2. PARTS

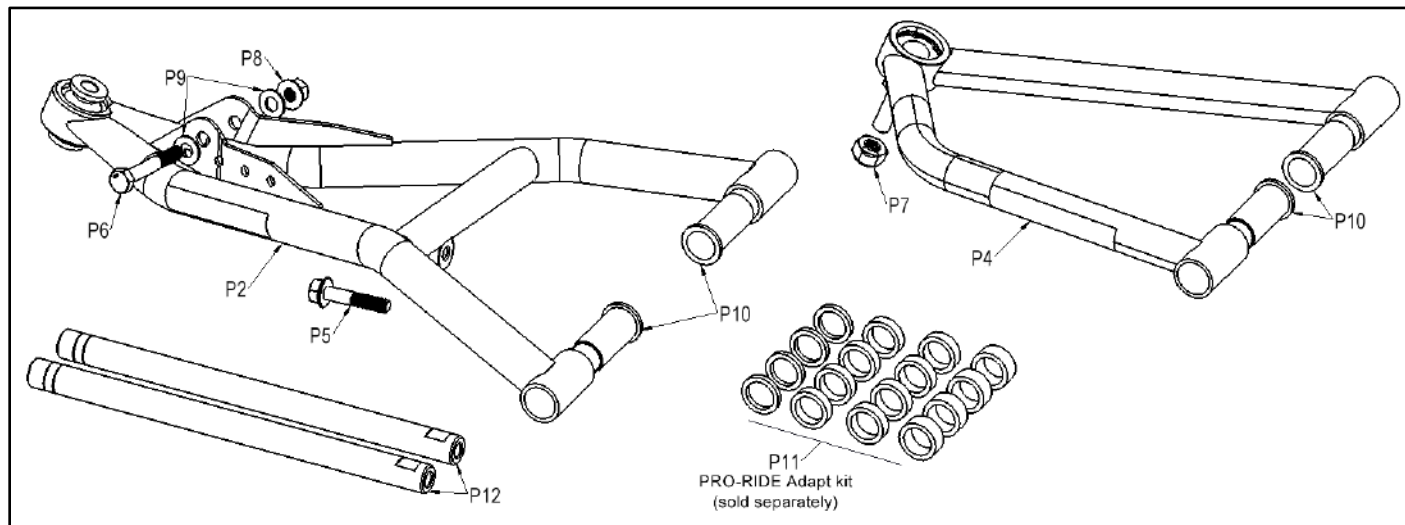

ITEM	DESCRIPTION	PART NUMBER	QTY
P1	X-Treme Lower Left Control Arm (Not Shown)	X-TREME 36-LL	1
P2	X-Treme Lower Right Control Arm	X-TREME 36-LR	1
P3	X-Treme Upper Left Control Arm (Not Shown)	X-TREME 36-UL	1
P4	X-Treme Upper Right Control Arm	X-TREME 36-UR	1
P5	M8 X 40 mm Hexagonal Flanged Screw	K05-X-TREME-36-L	2
P6	M8 X 55 mm Hexagonal Flanged Screw	K05- X-TREME-36-L	2
P7	M10 Nylon Lock Nut	K05- X-TREME-36-U	2
P8	M8 Nylon Lock Nut	K05- X-TREME-36-L	2
P9	M8 Washer	K05- X-TREME-36-L	4
P10	Acetale Bushing	K05- X-TREME-36-L / K05- X-TREME-36-U	4
P11	White plastic shim	K05-PRO-RIDE Adapt Kit (sold separately)	-
P12	Tie Rode	TRD	1

3. VEHICLE PREPARATION

Read all the instructions carefully before installing the product.
Make sure you have enough space to work properly.
Make sure to have the required tools.
Raise the front of the snowmobile until the skis no longer touch the ground.

⚠ WARNING

If you are using a lift system, pay special attention to the area where you will be lifting the vehicle. There is a risk of being crushed under inappropriately positioned lifting equipment. Never place any part of your body under a vehicle that has not been properly installed and secured.

Note: Unless differences occur between left hand (LH) and right hand (RH) sides, the procedures are shown for only one side of the vehicle. Repeat for other side. Right and left sides are defined as when sitting on the vehicle.

3.1 Remove and discard screw, nut, keep washers located on lower control arm of suspension.

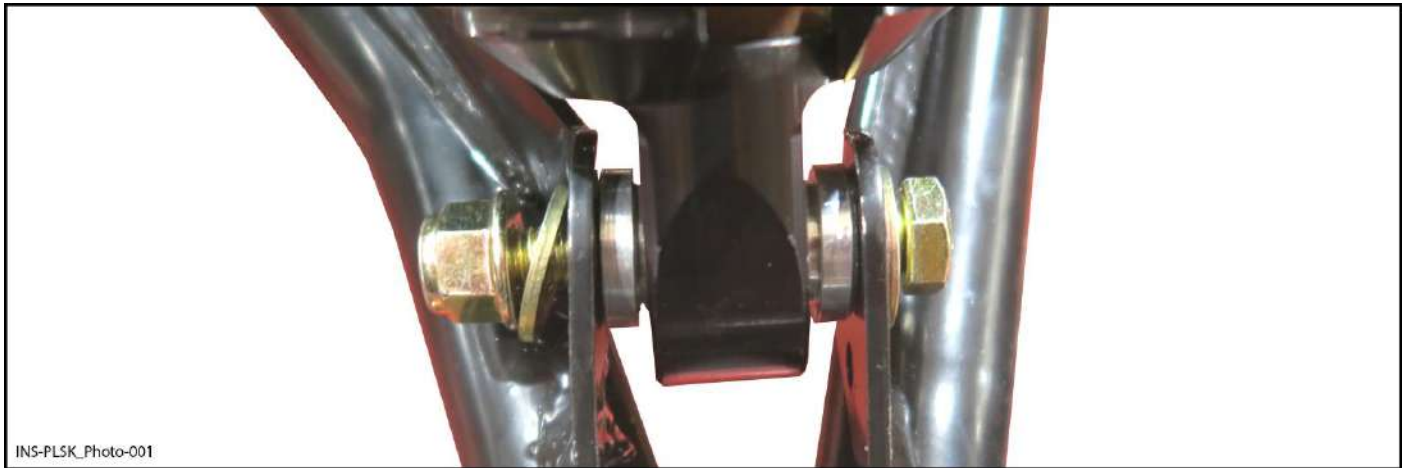

3.2 Remove and discard screw located in middle of leg retaining stabilizer bar.



3.3 Remove and keep the screw, nut and washers. Start with lower one to provide access to upper nut. Remove upper nut and remove arms from ski leg.

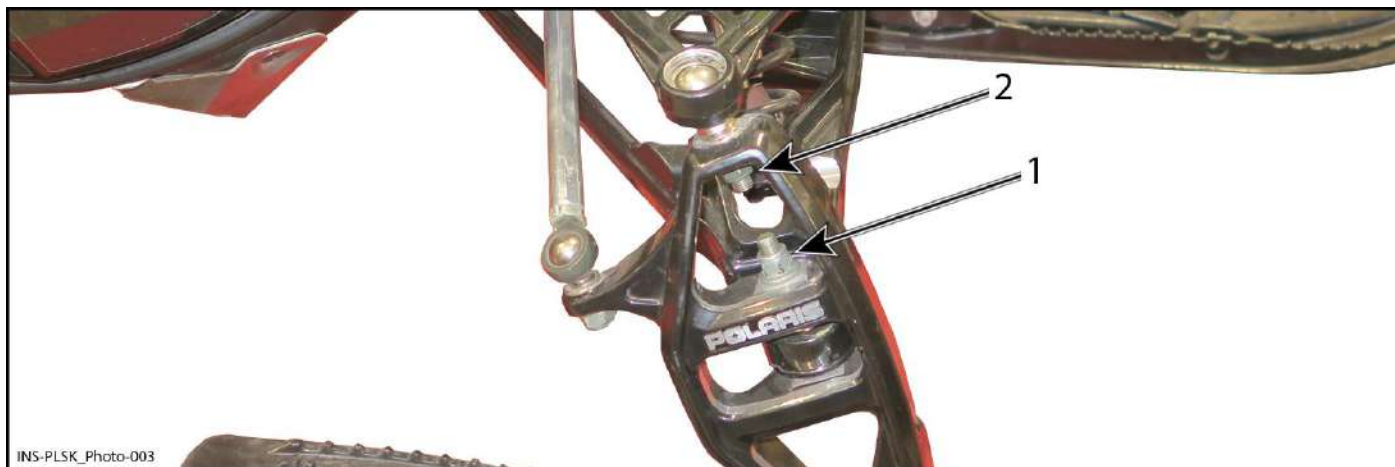

INS-PLSK_Photo-003

- 1- Lower nut and washer
- 2- Nut at top of leg

3.4 Remove and keep the screw that goes through chassis, remove and keep the three (3) nuts that hold lower arm in place. Remove lower arm.

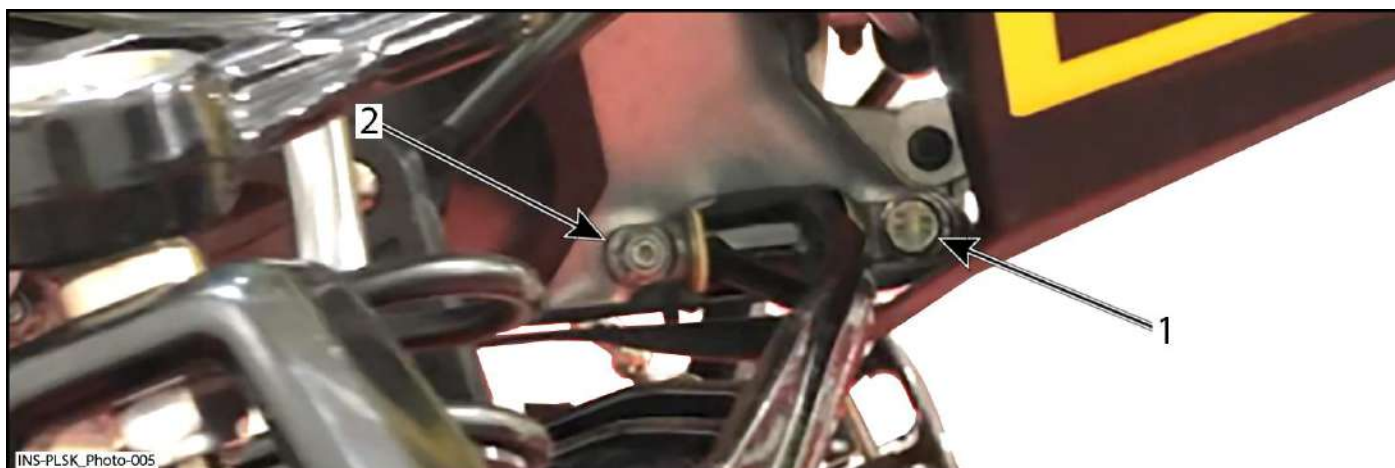

INS-PLSK_Photo-005

- Front section shown
- 1- Screw that goes through chassis
 - 2- Nut



INS-PLSK_Photo-004

Rear section shown

3.5 Remove and keep the four (4) nuts holding upper arm and remove upper arm.

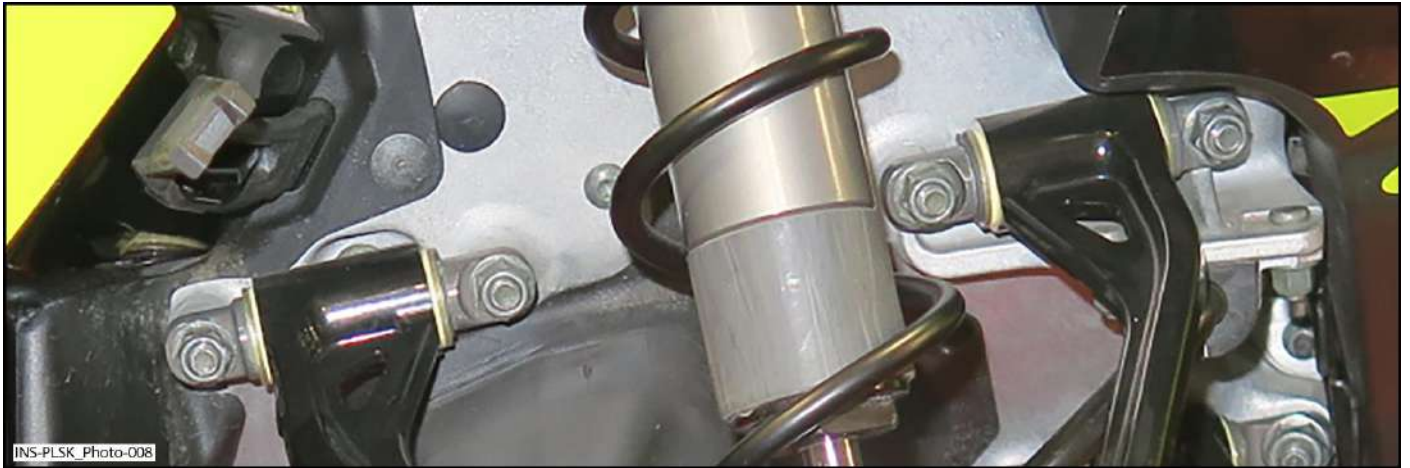

3.6 Hold one end of OEM arm and using snap-ring pliers remove retaining ring that holds pivot in place. Remove and keep washers, retaining ring and pivot.

NOTICE

Be careful not to break retaining ring.



4. INSTRUCTIONS

All models

4.1 Insert acetal bushing [P10] into the lower and upper assembly.

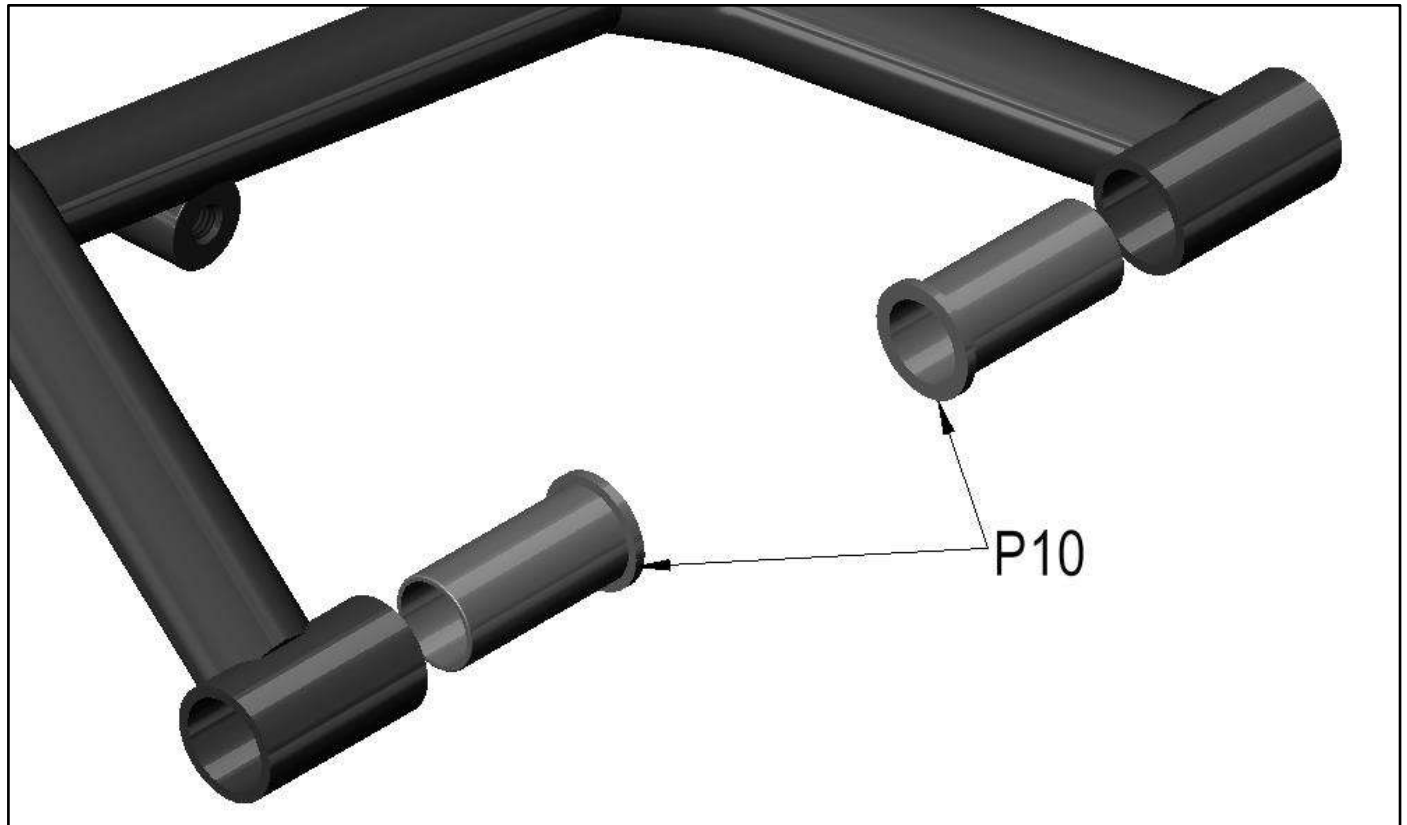

▲ CAUTION

Make sure to insert acetal bushing from the inside of the suspension arm as show on the figure above.

For models using PRO-RIDE platform – with optional PRO-RIDE Adapt kit

4.2 Install the pivot of the suspension arm as removed originally from the vehicle. Add white plastic bushing (included in the optional PRO-RIDE Adapt Kit [p11]), select the appropriate bushing thickness in order to have the proper fit once the suspension arm is in place on the vehicle. Go to step 4.3.



All models

4.3 Perform the pivot arm assembly. Insert pivot, washer and retaining ring as show on the picture below.

⚠ CAUTION	
Pay attention to direction during assembly. It is important to disassemble and reassemble vehicles originals parts in an identical manner.	
B-PWR sticker indicates the front of the arm	

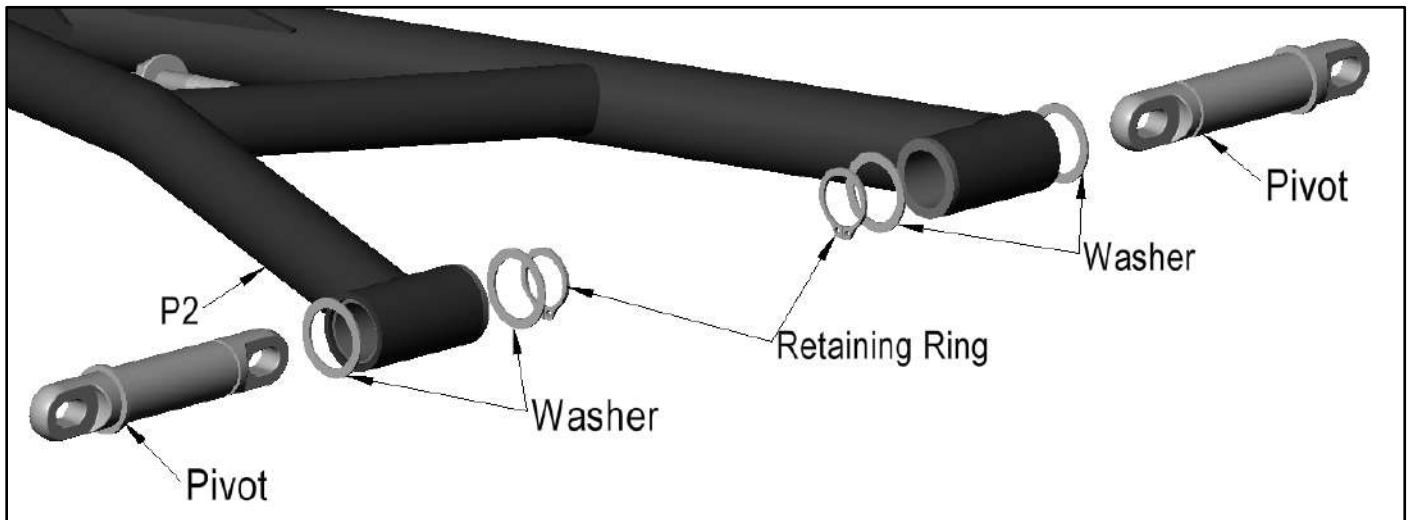

4.4 Put lower right suspension arm [P2] in place with nuts and put screw back on.



TIGHTENING TORQUE	
	41 N•m (54N•m Lower Pivot Front Flanged Nut)

4.5 Install upper right suspension arm [P4] with four (4) nuts.



TIGHTENING TORQUE	
	41 N•m

4.6 Install upper right suspension arm [P4] on top of ski leg with M10 Nylon Lock Nut [P7]. Tighten to specification.



TIGHTENING TORQUE	
M10 Nylon Lock Nut [P7]	54 N•m

4.7 Insert lower right suspension arm [P2] into center part of ski leg using screw, washer and nut previously removed. Tighten to specification.



TIGHTENING TORQUE	
	54 N•m

4.8 Install the stabilizer bar on lower right suspension arm [P2] with M8 X 40 mm hexagonal flanged screw [P5]. It must be facing towards shock absorber.



TIGHTENING TORQUE	
M8 X 40 mm Hexagonal Flanged Screw [P5]	27 N•m

4.9 Installing shock absorber on lower right suspension arm [P2] using M8 X 55 mm hexagonal flanged screw [P6], two (2) M8 washer [P9] and M8 nylon lock nut [P8].

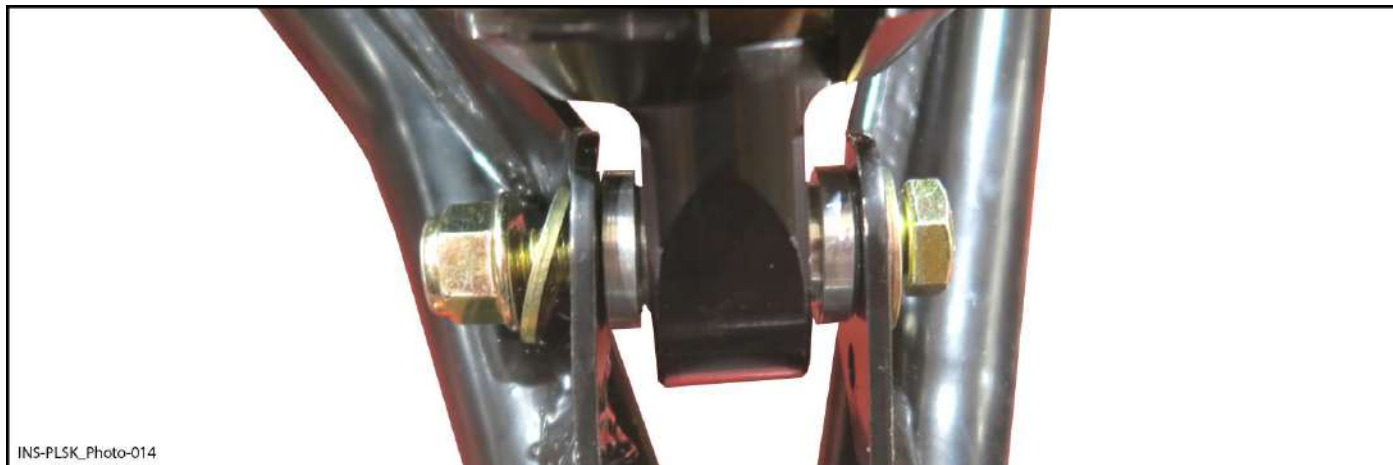

TIGHTENING TORQUE	
M8 nylon lock nut [P8]	31 N•m

4.10 Repeat all preceding steps on the other side.

Tie rod replacement

4.11 Remove the steering ball joint protector on each side by unscrewing the christmas trees

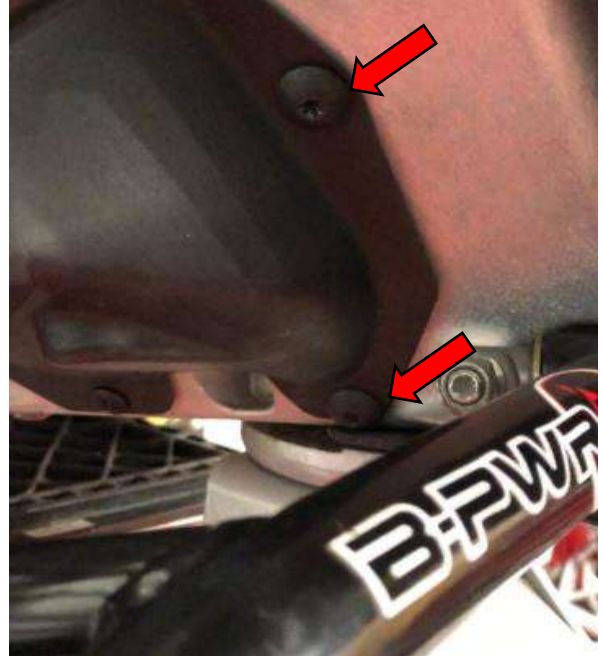

4.12 Loosen the 2 lock nuts that hold the steering rod and completely unscrew the steering column

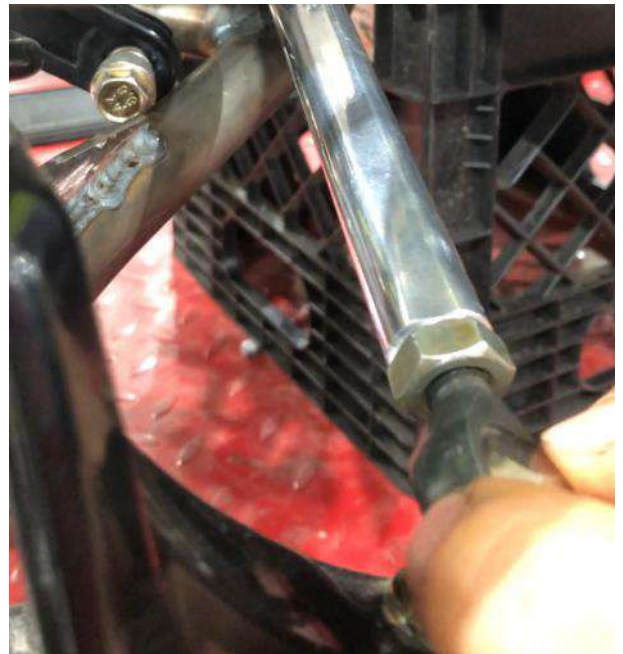

⚠ CAUTION

The nut in the guard is a left-hand thread nut.

4.13 Slide the steering rods [P12] into the protectors and screw them to the two ball joints respectively.

⚠ CAUTION

Be sure to orient the rod so that the left thread (circular groove side) is on the inside of the guard

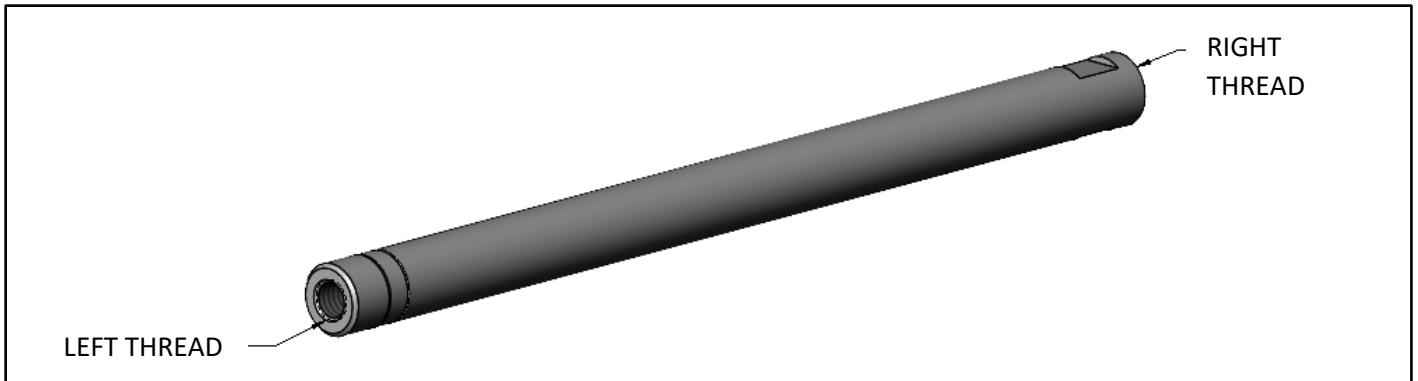

TIGHTENING TORQUE

Tie Rode End Jam Nut

15 N•m

⚠ CAUTION

Make sure to proceed to the alignment of your ski, refer to your vehicule manual for the details procedure.

4.14 Once the alignment is complete, put the steering ball joint protectors back in place on each side by screwing the christmas trees

