



INSTALLATION GUIDE

Thank you for choosing a B-PWR product, designed by passionate riders who focus on what users really need.

1. SAFETY INSTRUCTIONS

To avoid any unfortunate situations, we recommend that you get to know how your modified vehicle handles before using it in extreme conditions.

Read all the instructions carefully before installing this product.

If you do not have the tools or technical knowledge needed to ensure proper installation, have the product installed by an authorized dealer.

⚠ WARNING

It is essential that you follow the installation procedures, possess general mechanical knowledge and use appropriate tools to ensure a safe and reliable installation.

Improper use or installation of the product, or any modifications made to adapt the product for use in a context other than that for which it was intended, voids the warranty and may result in **SERIOUS INJURIES**.

B-PWR and all its affiliated companies, as well as its suppliers and distributors, are not responsible for any consequences whatsoever resulting from an incorrect installation or an improper use of the product.

This guide provides detailed instructions for installing the product.

AVAILABLE KIT

ACFB

COMPATIBILITY

Arctic-Cat Catalyst platform

⚠ WARNING

For safety reasons, this kit needs to be installed by a person with general mechanical knowledge using the proper tools.

The illustrations in this document indicate the typical structure of the various assemblies. It is therefore possible that they do not represent the exact form of the parts or the manufacturing details. These illustrations are intended to identify parts that perform an identical or similar function.

2. PARTS – ACFB

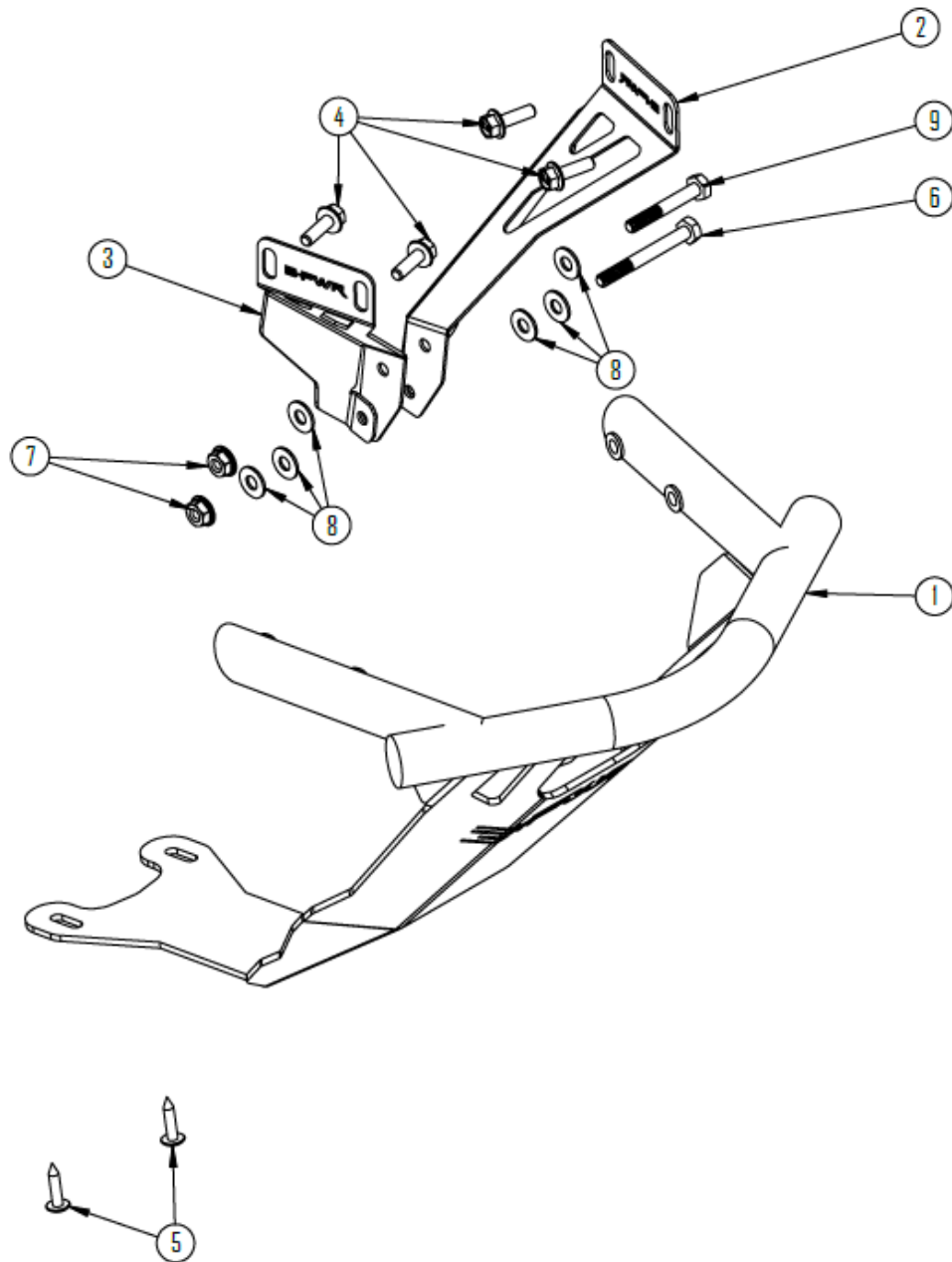

PARTS	DESCRIPTION	QTY	PART NUMBER
P1	Front bumper	1	
P2	Left brace	1	
P3	Right brace	1	
P4	Flanged hex head screw M6 x 1.0 x 16mm	4	K05-ACFB
P5	Button head screw Phillips #10	2	
P6	Hex head screw 1/4-20 x 2-1/4"	1	
P7	Lock nut 1/4-20	2	
P8	Flat washer, Dia. 1/4"	6	
P9	Hex head screw 1/4-20 x 1-3/4"	1	

3. VEHICULE PREPERATION

- 3.1 Read all the instructions carefully before installing the product.
- 3.2 Make sure you have enough space to work properly.
- 3.3 Refer to vehicle owner's manual for removal of various panels and other parts.

Note : unless there is a difference between the left and right side of the snowmobile, the following steps and procedures will only be applied to one side of the snowmobile. We expect you to use the same steps for the other side of the snowmobile. Left and right side are defined as when sitting on the vehicule.

4. INSTRUCTIONS

4.1 Remove the OEM front bumper. Once the bumper is removed, you can now remove the OEM front skid-plate. (See picture below to better understand the starting point).



4.2 Once the front skid-plate has been removed, take your front braces [P2] and [P3] and insert a flat washer [P8] in each brace. Pre-assemble your hardware as shown in the picture below.

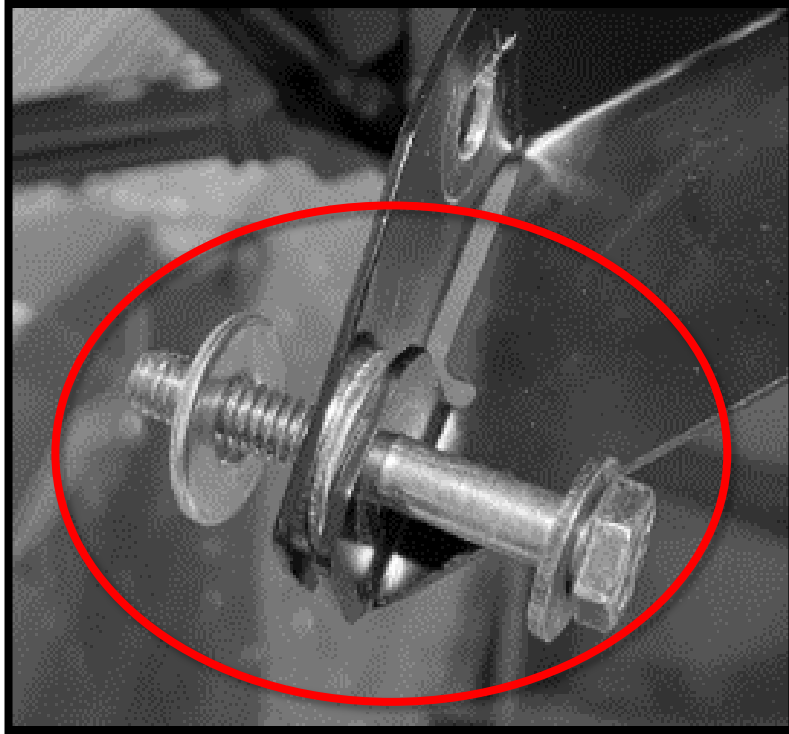

4.3 Install both front braces on the snowmobile. Pay attention to the washer installation sequence, as a wrong sequence will result in an improper installation. Once both braces and hardware are installed, only hand tighten the 1/4-20 nuts [P7] included in the hardware kit.

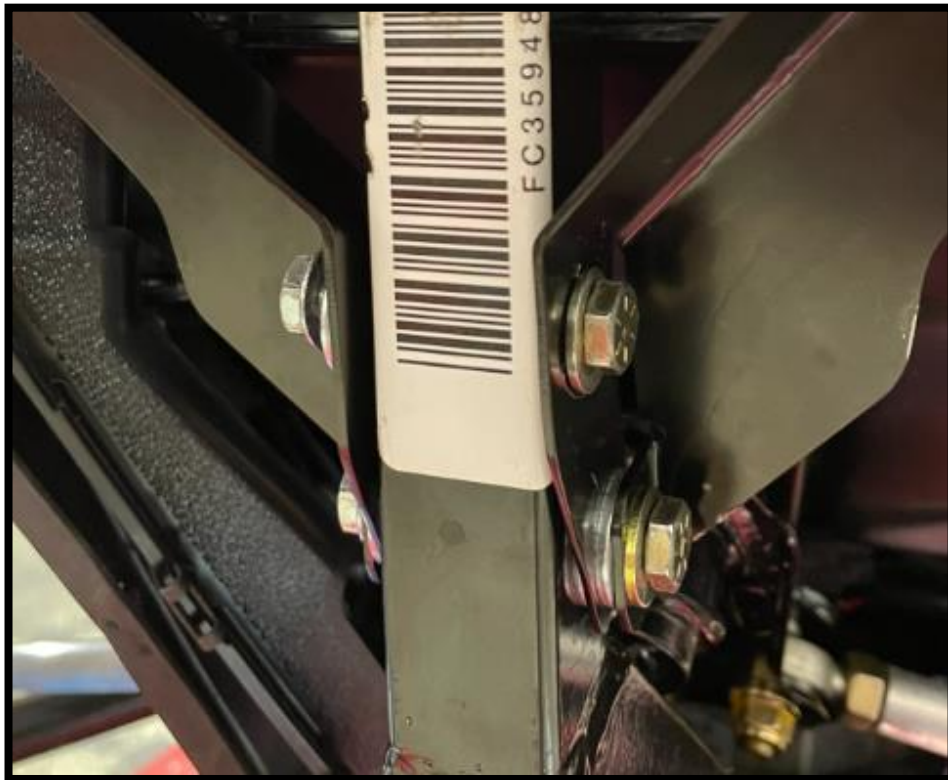

4.4 Align the front brace plates with the already existing upper holes in the snowmobile's frame. The top face of the plates should line up with the top of the snowmobile's plastic frame. (See picture below for more details).



4.5 Once the plates properly aligned, tighten both ¼-20 nuts [P7] to the builder's specifications.

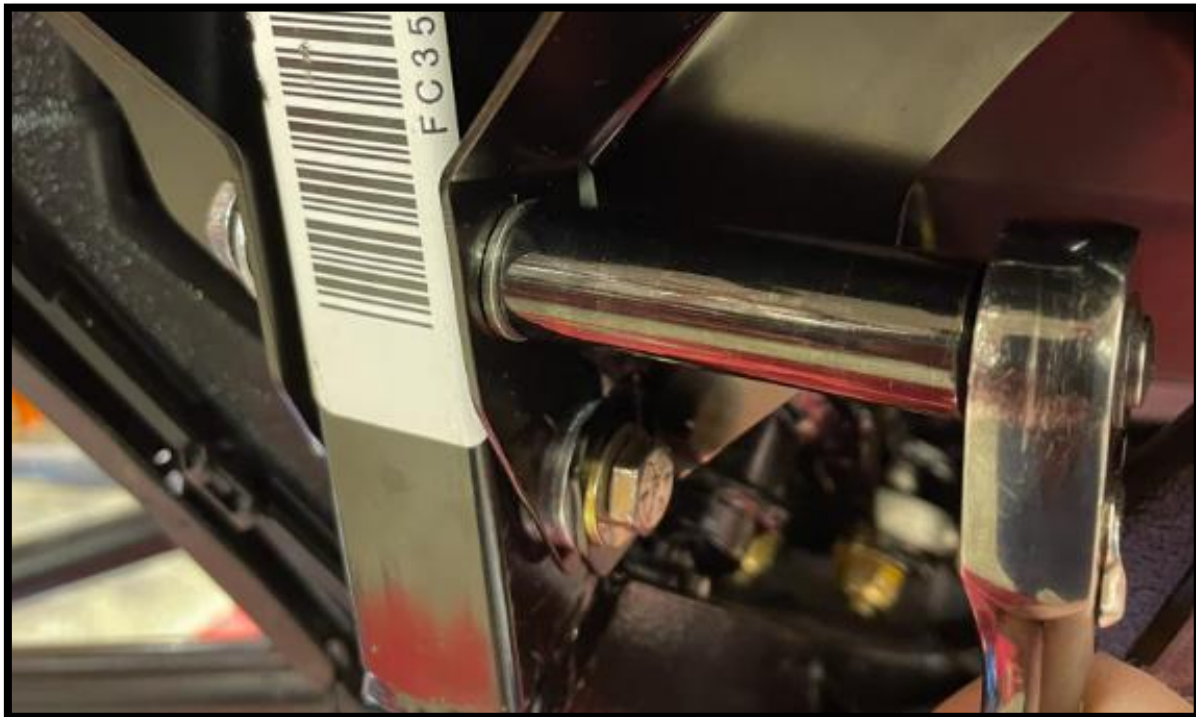

TORQUE SPECIFICATION	
Lock nut ¼-20 [P7]	10 N•m ± 2 N•m

4.6 Reinstall the front skid-plate on top of the front brace plates. Make sure that the skid-plate is properly mounted to the snowmobile.

(See pictures below for more details).



4.7 Once all the skid-plate hardware is reinstalled, insert the front bumper [P1].



4.8 Install the four flanged hex screw [P4]. Do not fully tighten them until threads are engaged on all four corners.



4.9 Tighten the four screws [P4] to the builder's specifications.



TORQUE SPECIFICATIONS	
Flanged hex head screw M6 x 1.0 x 16mm [P4]	10 N•m ± 2 N•m

4.10 Install the two #10 Phillips screws [P5] in the original holes underneath the snowmobile. Tighten the screws to the builder's specifications.



TORQUE SPECIFICATIONS	
#10 Phillips screw [P5]	8 N•m ± 2 N•m

End of installation, thank-you for choosing B-PWR.